

Jesus loves you. Walk with him.

BETHELITE

NOVEMBER 3, 2021: VOL. 70, NO. 21

THIS ISSUE:

ALL SAINTS DAY CELEBRATION

For Saints Both Living and Passed

A GENEROUS LIFE

The Beauty in Giving

COLUMBARIUM SURVEY

Bethel Seeks Your Input

BASIC NEEDS INSECURITY AMONG STUDENTS AT UW-MADISON

*How UW and Lutheran Campus Ministry
Are Addressing Those Needs*

CARING FOR CREATION

*Fixing Climate Change with
Faith, Hope, and Love*



BETHEL

LUTHERAN CHURCH

*Color Bethelite provided in part by
Bethel Endowment Foundation*

THE GLORY BEHIND THE SHADOWS

In his book *With*, author Skye Jethani describes the mausoleum of Galla Placidia in Italy: “Fifteen hundred years ago, the emperor of Rome built a tomb for his beloved sister. The small building was designed in the shape of a cross with a vaulted ceiling covered with mosaics of swirling stars in an indigo sky. The focal point of the mosaic ceiling was a depiction of Jesus the Good Shepherd surrounded by sheep in an emerald paradise. The mausoleum of Galla Placidia still stands in Ravenna, Italy, and has been called “the earliest and best preserved of all mosaic monuments” and one of the “most artistically perfect.” But visitors who have admired its mosaics in travel books will be disappointed when they enter the mausoleum. The structure has only tiny windows, and what light does enter is usually blocked by a mass of tourists. The “most artistically perfect” mosaic monument, the inspiring vision of the Good Shepherd in a starry paradise, is hidden behind a veil of darkness. But the impatient who leave the chapel will miss a stunning unveiling. With no advance notice, spotlights near the ceiling are turned on when a tourist finally manages to drop a coin into the small metal box along the wall. The lights illuminate the iridescent tiles of the mosaic but only for a few seconds. One visitor described the experience: ‘The lights come on. For a brief moment, the briefest of moments—the eye doesn’t have time to take it all in, the eye casts about—the dull, hot darkness overhead becomes a starry sky, a dark-blue cupola with huge, shimmering stars that seem startlingly close. ‘Ahhhhh!’ comes the sound from below, and then the light goes out,



The Mausoleum of Galla Placidia, Ravenna, Italy

312 Wisconsin Ave, Madison, WI 53703

608.257.3577 www.bethel-madison.org



Pastor Mike

pastormikebrown@bethel-madison.org

419.345.2836

and again there's darkness, darker even than before.' The bright burst of illumination is repeated over and over again, divided by darkness of unpredictable length. Each time the lights come on, the visitors are given another glimpse of the world behind the shadows, and their eyes capture another element previously unseen—deer drinking from springs, Jesus gently reaching out to his sheep that look lovingly at their Shepherd. After seeing the mosaic, one visitor wrote: "I have never seen anything so sublime in my life! Makes you want to cry!" In the Bible, Isaiah 6:1-8 records a similar experience when he writes: "

In the year that King Uzziah died, I saw the Lord sitting on a throne, high and lofty; and the hem of his robe filled the temple. Seraphs were in attendance above him; each had six wings: with two they covered their faces, and with two they covered their feet, and with two they flew. And one called to another and said: 'Holy, holy, holy is the Lord of hosts; the whole earth is full of his glory.'

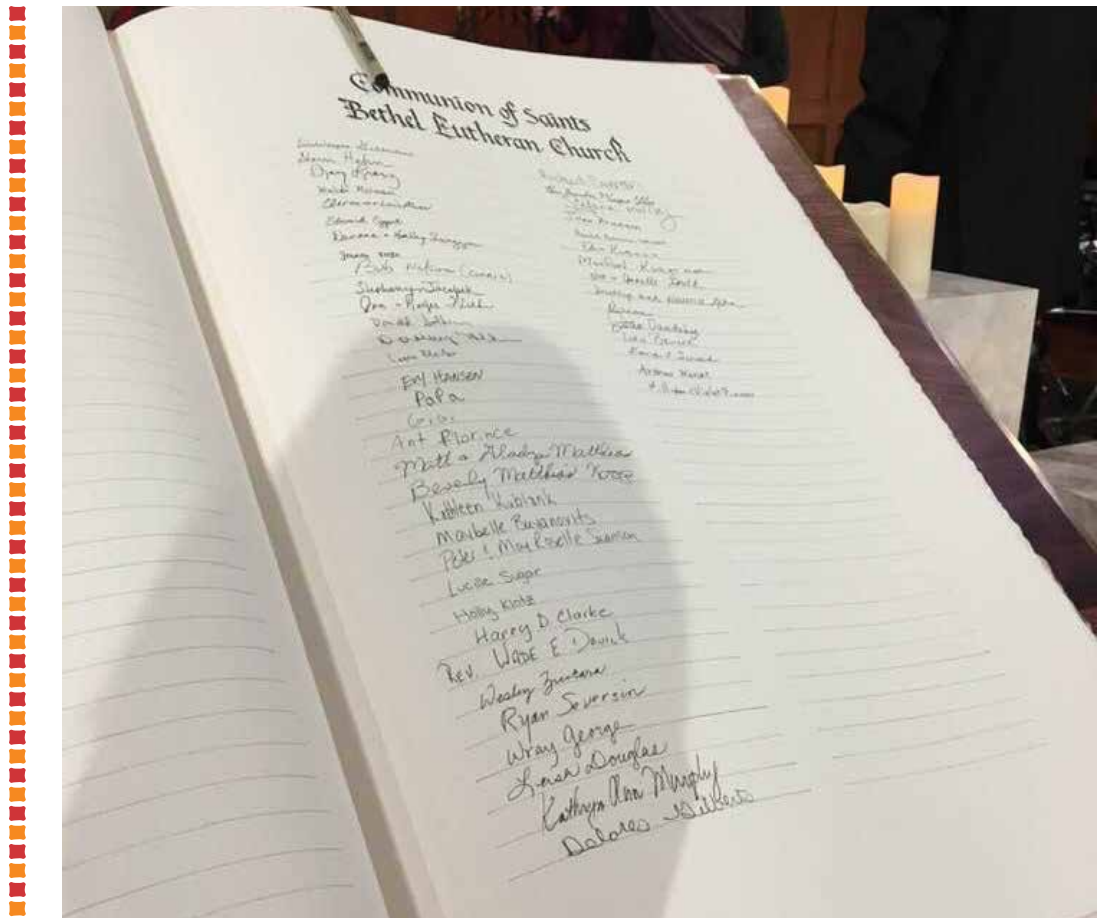

All are invited to write the name of a loved one in the Bethel book of life on All Saints Sunday, Nov. 7

The pivots on the thresholds shook at the voices of those who called, and the house filled with smoke. And I said: 'Woe is me! I am lost, for I am a man of unclean lips, and I live among a people of unclean lips; yet my eyes have seen the King, the Lord of hosts!' Then one of the seraphs flew to me, holding a live coal that had been taken from the altar with a pair of tongs. The seraph touched my mouth with it and said: 'Now that this has touched your lips, your guilt has departed and your sin is blotted out.' Then I heard the voice of the Lord saying, 'Whom shall I send, and who will go for us?' And I said, 'Here am I; send me!'"

By most accounts, King Uzziah was a good king for Israel and presided over a period of stability and prosperity. In the year of his death, the prophet Isaiah goes to the holy space, the Temple, and grieves. In his grief, he experiences the glory of the Lord. The bright light of God's majesty and holiness fill the space and enter Isaiah's mind and spirit. It is a beautiful passage of encouragement and support that shows Isaiah

"In the year that King Uzziah died, I saw the Lord."

receiving strength to carry-on.

Both Isaiah and the Roman emperor in 425 had similar experiences of encountering the bright glory of the Lord in the darkness of life's shadows. Each year at Bethel on All Saints Sunday, we enter the darkened sanctuary and

illuminated by candles and heavenly light to remember the passing of the faithful departed. On this day we could each begin a chapter of our story "In the year my _____ died." And like Isaiah, we can find God's mighty and holy presence

filling the room with encouragement and strength the carry-on. May your past losses bring you to the place of God's presence on November 7 as we sit and behold the wonder of the Lord. 🌈

ALL SAINTS DAY CELEBRATION

For Saints Both Living and Passed



On November 7, at the 9am and 10:30am worship services, Bethel offers a one-of-a-kind worship experience where we remember and celebrate the lives of people of faith, living and passed. A “saint” is not some spiritual super hero or holier-than-thou persona. A “saint” is simply a person who has been drawn into the mystery and reality of Jesus’ resurrected life. All who are baptized into his living spirit are “Saints”.

As we gather together on Nov 7 in the sanctuary, worship will be wrapped in wondrous light with streams of white. Special care has been taken to infuse the space with a heavenly air and mood.

Because All Saints Sunday brings with it the memory of loved ones passed, worship will begin with an honoring of those beloved people. You are welcome, even encouraged, to gather in the sanctuary before worship begins to write the name of a loved one who has passed recently or long ago. A “Book of Life” will be laid-out at the front of the church for you to record your loved ones’ names. You are also invited and encouraged to light a candle and place it in the box filled

with sand in memory of someone, a saint living or past.

Come early. Stay late. Bask in the pure white glow of a service that is like heaven on earth.

Names of the faithful departed (since last All Saints):

Sylvia Bailey
 Delma Baker
 Betty Barsness
 Bonnie Barstad
 Owen Bekkum
 Norv Bernhardt
 Phil Brickson
 Norma Brooks
 Ferne Brown
 Bob Cleveland
 Mariann Crose
 Marvin Droster
 Phyllis Easterday
 Bob Espeseth
 Phyllis Foster
 Andrew George
 Eileen Gordon
 Elroy Gunderson
 James Hanson
 Donna Hilgendorf
 Theodore Klade

Phyllis Kolseth
 John Kutzbach
 Alice Kvamme
 Earl Larson
 Betty Lewis
 Marion Lewis
 Richard Marleau
 Curtis Martinson
 David Martinson
 Al Moe
 Stephen Napier
 Marlin Nelson
 Darwin Ness
 Millie Osborn
 Marian Osterberg
 Richard Otis
 Margery Ross
 Carol Schaber
 Kurt Simatic
 Gretchen Smith
 Joanne Sprecher
 Tom Ullsvik
 Maggie Werndli

Names of the recently baptized (Since last All Saints):

Abigail Bisbee
 Lyla Collins
 Jonathan Gerlach
 Vernon Goff
 August Hayes
 Maya Hurley
 Kamden Kraemer
 Leo Kueppers
 Colton McKiddy
 Elyse Novara
 Hayes Paulson
 Mendel Taylor
 Sylvie Turcott
 Adelina Webber
 Graham Wilson
 Ryder Wilson 🌈



A GENEROUS LIFE

The Beauty in Giving

During the weeks between November 14 and 21, Bethel will open the scriptures to hear the freeing teachings on matters of generosity. Jesus' blessings fill the creation, cover the earth, and reach areas of deepest value. In this season of stewardship, we focus on how Jesus reaches our deepest values and practices surrounding money. It will be a time of thanksgiving, of joy, and of beauty.

These coming weeks will be a time of much sharing, of great thanksgiving, and of responding to Jesus' call to each one of us to bring ourselves, our time, our talents, and our treasures to his care. **A Generous Life Stewardship** packets are in the mail and coming your way with blessing and opportunity.

If you have any questions, please contact Alice at alicem@bethel-madison.org 🌈



GIVING

Stewardship Campaign November 14-21

“Beautiful Savior” is one of the all time favorite hymns of the church. Martin Luther said that what is true of Jesus is true of us as well. In his death and resurrection, Jesus gives us all that he has and all that he is, without reservation. That means that you are beautiful just as he is beautiful. Even more, because his beauty is expressed in giving and generosity, your generosity is part of what makes you beautiful. Like God, your generosity flows into the world. As the Bible says in 2 Corinthians 9:8, “God will generously provide all you need. Then you will always have everything you need and plenty left over to share with others.” Even through a

example of God's presence in our lives. To help you express your generosity, Bethel is sending out a stewardship packet. The items in this packet are meant to be used in conjunction with weekend worship. A pamphlet, *A Generous Life: The Beauty in Giving* will give you a Biblical approach to thinking about money and giving. A pledge card and return envelope is provided for you to make a financial commitment to Bethel in 2022 as part of God's ongoing presence in your life.

Please bring or mail in a completed pledge card to the church by November



second year caught in the grips of a worldwide pandemic, God grip on you has not slipped. God continues to hold you close and provide for you. Your generosity flows from God's generosity.

This year's annual stewardship campaign highlights how generosity is a concrete

29. In addition to sharing your financial commitment, we also want to hear how you are doing personally. For this, we have included a “Spiritual Vitality Check.” Feel free say as much or as little as you wish. 🌈

IS BEAUTIFUL



THE THREE BAPTISMS

Martin Luther once wrote that everyone needs to experience three baptisms: the heart, the head, and the wallet. His experience taught him that in order to experience the fullest measure of God's redeeming love in Jesus, Christians needed all three realities to come under the authority of the Lord. Our hearts need to be continually immersed in the waters of grace to wash away the guilt, shame, anger, and sadness that accumulates day after day. Our minds need to be flooded over and over again in the waters of new life to bring our thought life into conformity with the mind of Christ. And



our wallets or purses need to be submerged in the waters of freedom to help us step into a life of generosity and sacrificial giving as Jesus lived. Luther once made the funny observation that many people go through the waters of baptism holding their wallets or purses over their heads. There can be a fear that if the water touches our finances and we start giving it away there may not be enough. But as Jesus teaches again and again, giving is the way to the good life. Generosity makes one rich. Living a life of trust and financial obedience to God's ways opens a whole new experience of abundance and joy. 🌈

ELECTRONIC GIVING

Whether a one time contribution or a regular giving, Bethel offers several ways to support a giving method that suits your needs. Visit the Bethel website at

www.bethel-madison.org/give

and select the options that work for you. 🌈



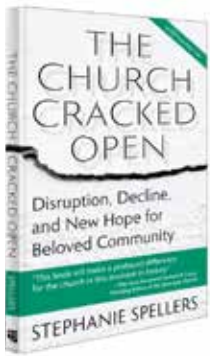

AN INVITATION TO BELOVED COMMUNITY

What kind of community is God calling us to be – especially mid pandemic, racial reckoning and church decline? How is “beloved community” possible now?

These are questions we'll consider in the first of three discussions of *The Church Cracked Open* by Stephanie Spellers, our ACTJAM Big Read for November. Spellers is an Episcopal priest who is honest about the challenges and hopeful that we can be a church that seeks the flourishing of all.

Please join us Nov 7 or 8 to explore beloved community. We'll draw from *The Church Cracked Open* as well as Dietrich Bonhoeffer and the bible. No pre-read is necessary.

Sunday, Nov 7 at 10:15am – Good Shepherd Chapel

Monday, Nov 8 at 1pm – via Zoom (email actjam@bethel-madison.org for the link)

Community copies of *The Church Cracked Open* are available from the Bethel Library. 🌈

COLUMBARIUM SURVEY

Bethel Seeks Your Input

WHAT IS A COLUMBARIUM?

Just as the church cemetery next to the old country church was a powerful reminder of the “Communion of Saints” that surround us. A columbarium is a vault with niches for urns containing the ashes of cremated remains.

COLUMBARIUM INTEREST

The Columbarium Committee is gauging interest in the construction of a columbarium and memorial wall near the Sanctuary. We need your help!

Your level of interest and support will determine if we go forward with this project. We have viewed and researched other church columbariums in the area.

The preliminary drawing to the right provides a visual for the location of the proposed columbarium.

ANTICIPATED COST

We estimate the cost of a niche, which would

contain either one or two urns, between \$2,000-2,500. Memorial plaques would cost \$300.

SURVEY

Please fill out the survey online here: www.bethel-madison.org/columbarium

You can also download a copy of the survey to fill out and mail back to Bethel by Dec 1. Thank you in advance for this information.

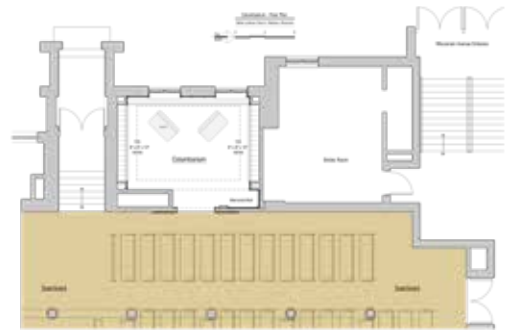

QUESTIONS

If you have any questions about this project, contact John Shanda at 608.575.3156. 🌈



Interior View



BASIC NEEDS INSECURITY AMONG STUDENTS AT UW-MADISON

Sunday, Nov 21 at 10:30am



Rev. Emily Tveite

Come to Bethel and hear how issues of hunger, housing, and mental health are affecting UW students and how the University and Campus Ministry are addressing those needs. You might be surprised to find out how and why these are very real struggles for students.

last 30 days. ... In fall 2020, the Hope Center found that 34% of college students experienced food insecurity 30 days prior.

Guests will be the Rev. Emily Tveite, Campus Pastor and Director, Lutheran Campus Ministry at the UW, and Dr. Bjorn Hanson, Psychologist and Coordinator of Data, Quality, and Informatics at UW-Madison. 🌈



Dr. Bjorn Hanson

A fall 2019 survey of nearly 167,000 students nationwide found that 39% of students at two-or four-year schools had experienced food insecurity in the

CARING FOR CREATION

Fixing Climate Change
with Faith, Hope & Love
Nov 9, 2021 at 7:30pm
via Zoom Webinar

Register Here:

www.bethel-madison.org/c4c 🌈



Bob Inglis, Executive Director,
republicEN.org



HOMELESS MINISTRY

Seeking Clothing & Winter Donations

Bethel's Homeless Ministry is again preparing for the coming of cold weather by requesting your assistance in providing specific seasonal clothing/hygiene items. Living "on the street" requires a great deal of strength, determination, and skill, especially during Wisconsin's fall and winter months. Our guests are in need of men's and women's thermal long underwear, men's briefs/boxer shorts, warm socks, hand and foot warmers, gloves and winter jackets. If you have a pair of gently used winter boots, please consider donating them.

We are deeply appreciative of your willingness to give to those who have the least. Please contact the church if you have questions or have an interest in becoming a volunteer with this vital ministry. 🌈



BETHEL
LUTHERAN CHURCH

312 Wisconsin Avenue
Madison, WI 53703

ADDRESS SERVICE REQUESTED
DATED MATERIAL: REQUESTED IN HOME BY NOV 5 2021

NONPROFIT ORG
U.S. POSTAGE

PAID

MADISON, WI
PERMIT 602

SEPTEMBER YEAR-TO-DATE FINANCIALS RESULTS

	YTD Actual	YTD Budget	Over/(Under) Budget
REVENUES			
Offerings	1,146,583	1,174,575	(27,992)
Miscellaneous revenue	89,807	63,975	25,832
Non-operating revenue	262,953	268,213	(5,260)
Total Revenue	1,499,343	1,506,763	(7,420)
MINISTRY INVESTMENTS			
Staff	886,970	986,927	(99,957)
Ministry & Resource Teams	254,568	292,988	(38,420)
Benevolence	75,654	81,244	(5,590)
Administration	74,074	64,575	9,499
Other	9,214	12,975	(3,761)
Total Ministry Investments	1,300,480	1,438,709	(138,229)
Total Net Income (Loss)	198,863	68,054	130,809

A complete copy of the financial statements are posted to Realm that you can access through your Bethel Realm profile.



bethel_madison



Bethel.Lutheran.Madison.WI



bethelmadison



BethelLutheranTV

Worship Times: Sunday at 7:30am & 9am - Traditional; 10:30am - Contemporary
Saturday at 5pm - Acoustic Casual; Thursday at 5:30pm - Sacred Space